

A0720022 Aberdeen L12 WW

Technical specifications:

LED system: 12x 1W warm-white LED
 Beam angle: 15°
 Power consumption: 14.1W / 600Lm
 Power connection: 24V DC by LED-Power supply
 Housing + mounting base: Grey powder coated die-casting aluminum
 (T=50-55µm Adhesion of I/ASTM class 4B)
 Glass: Tempered glass T=3mm
 Lens: optical lens, efficiency >85%
 Ambient Temperature: -0°C / +40°C
 Cooling system: Convection
 Included mounted H05RN-F 2x 1.0mm² L1.5m with mounted IP-68 male plug

Attention: This high power LED fixture cannot be installed under water

KG	Voltage	Class	LED- Power	15° Symmetric LED-Lens	IES-File	Ø 158 mm W 163 mm D 89 mm
2.16	24V DC	Class III	IP-65	12x 1W	available	Dimensions



Garden Spikes Not included

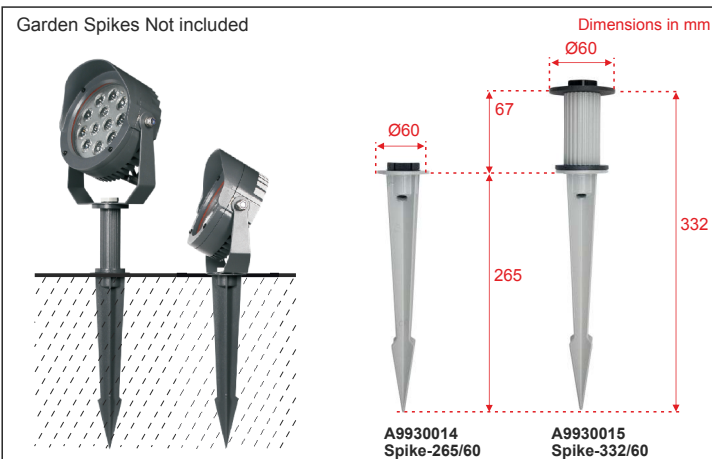

Accessories not included

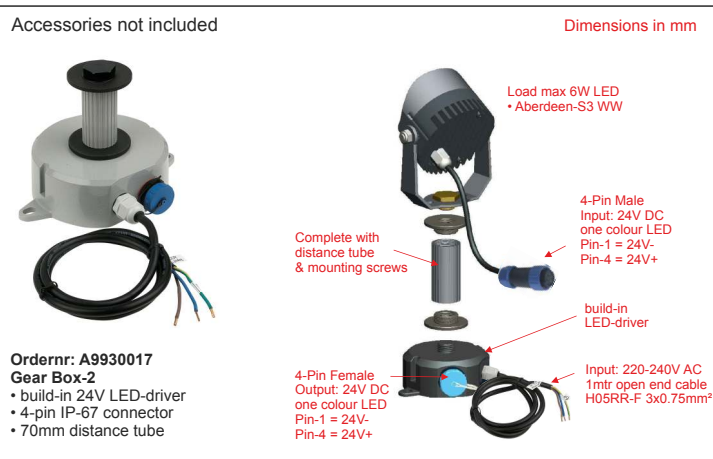

Dimensions in mm

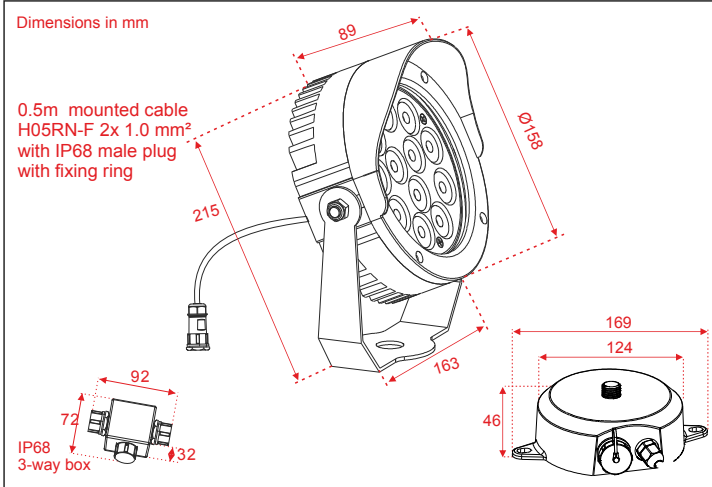

Dimmable

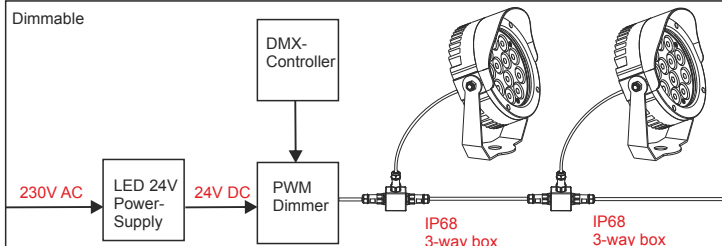

Non-Dimmable

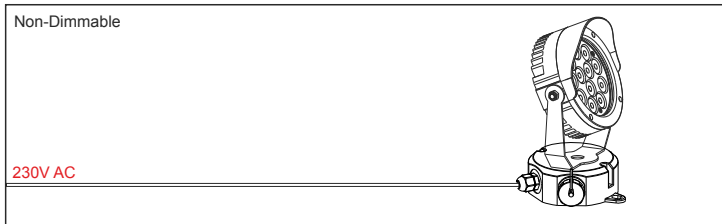

Garden Lights

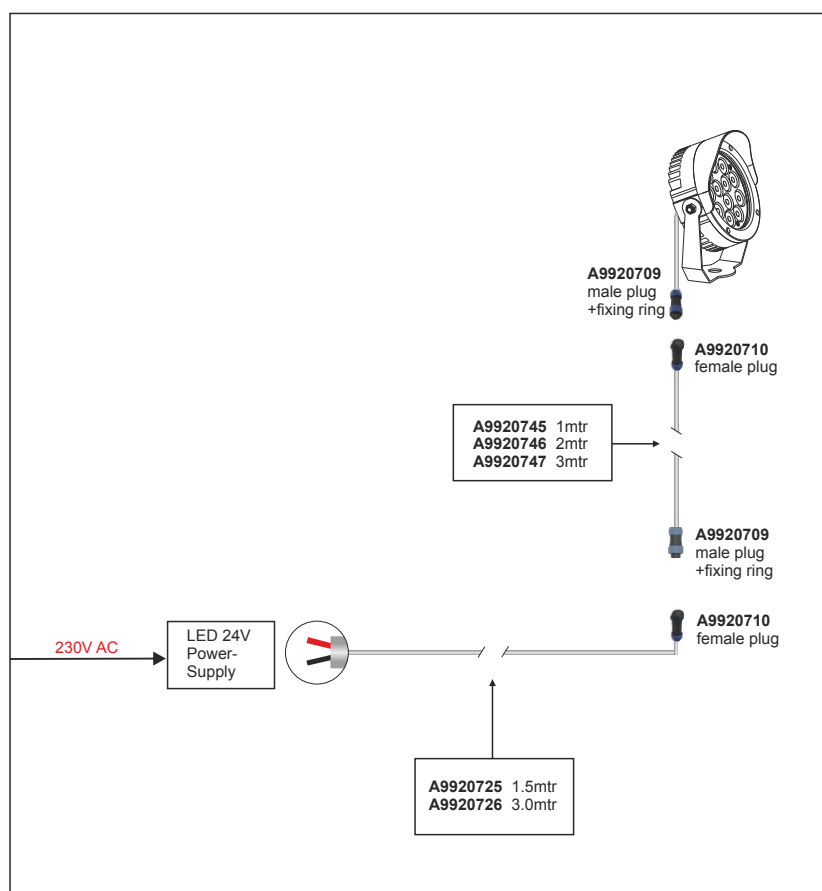
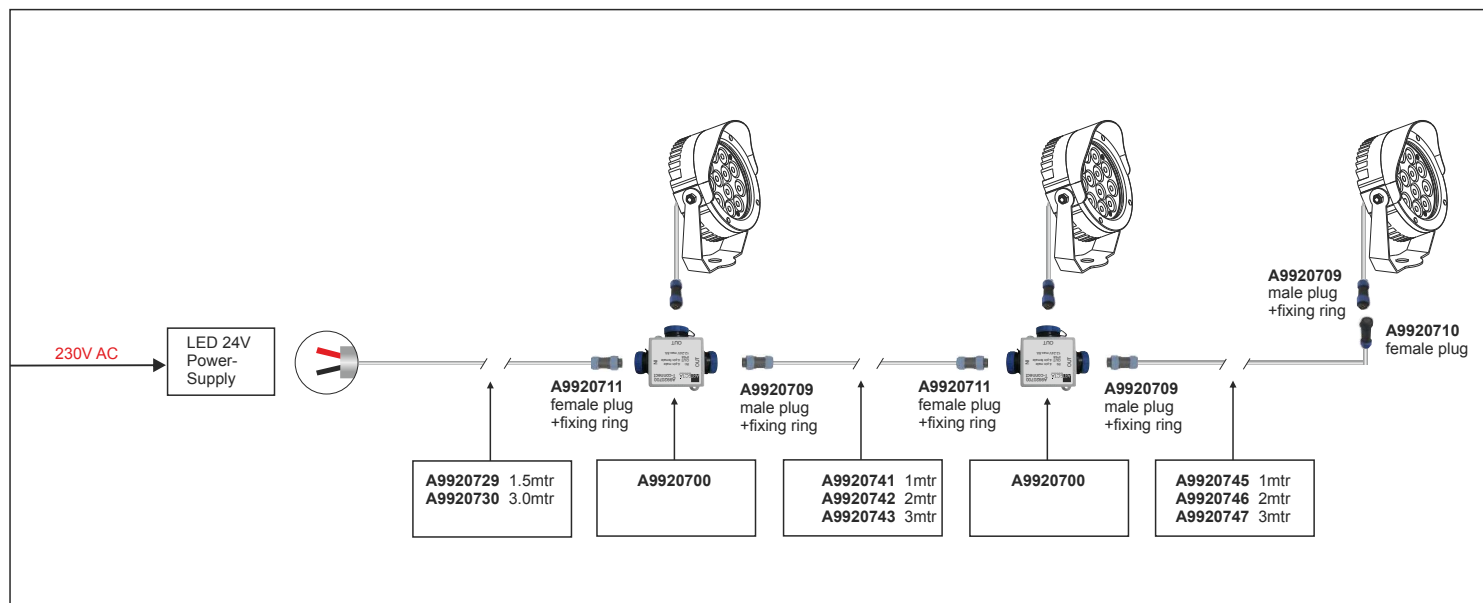

IP68 4-pin Chassis

A9920707 male
A9920708 female

IP68 4-pin Connectors

A9920709 male +fixing ring
A9920712 male
A9920711 female + fixing ring
A9920710 female

IP68 4-pin Extension Cables

male+fixing ring to female+fixing ring
(T-connect to T-connect)
A9920741 1mtr
A9920742 2mtr
A9920743 3mtr

IP68 4-pin Extension Cables

male connector+fixing ring to female connector
(T-connect to Fixture)
A9920745 1mtr
A9920746 2mtr
A9920747 3mtr

IP68 4-pin 24V Connecting Cables

female connector with fixing ring to 2 inner wires open end
(Powersupply to Fixture)
A9920725 1.5mtr
A9920726 3.0mtr

IP68 4-pin 24V Connecting Cables

female connector to 2 inner wires open end
(Powersupply to T-connect)
A9920729 1.5mtr
A9920730 3.0mtr

A9920700 T-connect IP68

1x 4-pin male
2x 4-pin female

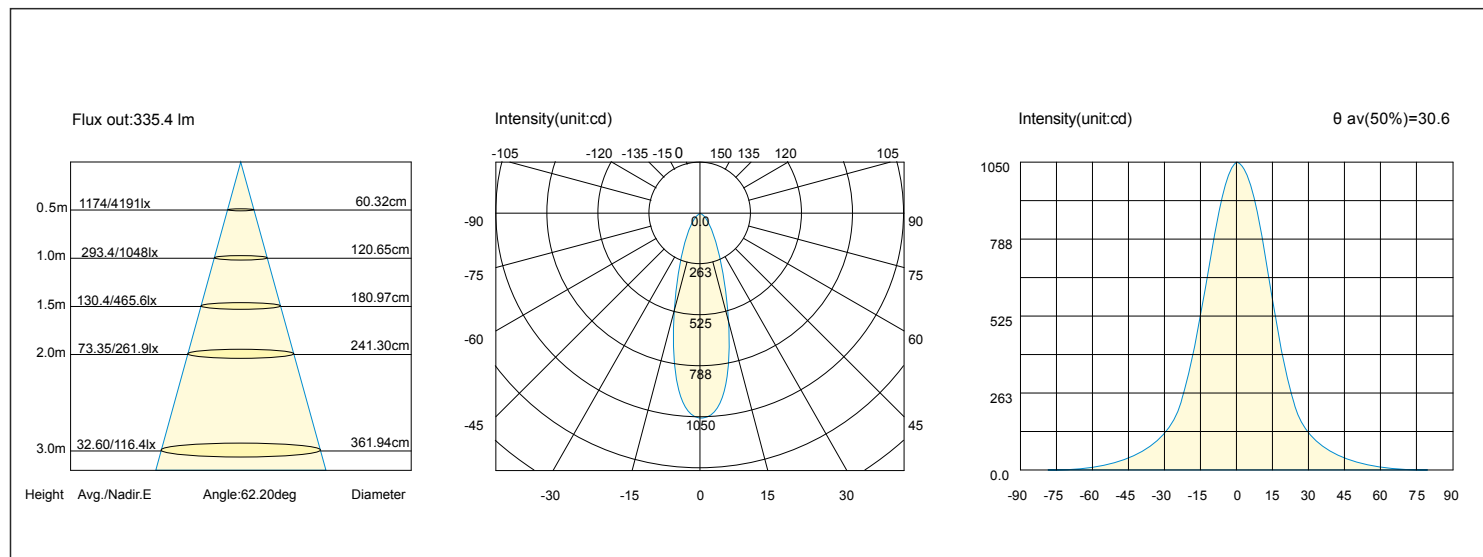

High voltage connection

